

### Features & Benefits

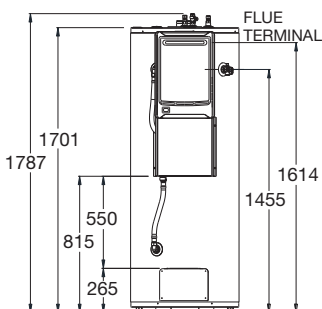

- Complete Frost Protection – Unique Drain-Back™ heat exchange technology
- Complies with regulations in all states
- Booster – 26 L/min 6-star continuous flow gas (site integrated)
- Full mains pressure for multiple outlets
- Integrated tempering valve
- 2 or 3 SPA2000 or CSA2007 collectors
- Eligible for STCs<sup>5</sup>
- 5 year cylinder warranty<sup>1</sup>

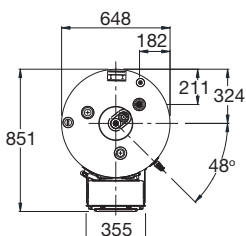

MODEL	596270
Storage Capacity (L)	270
Solar Collectors	2 or 3 SPA2000 2 or 3 CSA2007
Booster Type	Gas
Weight Empty - (kg) Tank without booster	168
Weight Empty - (kg) Tank with booster	187
Water Connections	Rp <sup>3</sup> / <sub>4</sub>
Gas Connections	R <sup>3</sup> / <sub>4</sub>



Scan code for details & installation instructions

